

How To Clean Your Pralinator Hub Seal Assembly

Weekly Cleaning Procedure

The instructional content provided is for general informational purposes only. It is to be used as a reference and is not to be considered a complete or exhaustive resource. Users should always consult the appropriate product manual for specific step-by-step instructions. If you are in need of further assistance, please contact Gold Medal directly at 800-543-0862 or email info@gmpopcorn.com.

Follow the directions below WEEKLY to ensure proper machine performance. **IMPORTANT:** For proper machine performance. **TOTAL CLEANING TIME:** Approximately 10 Minutes

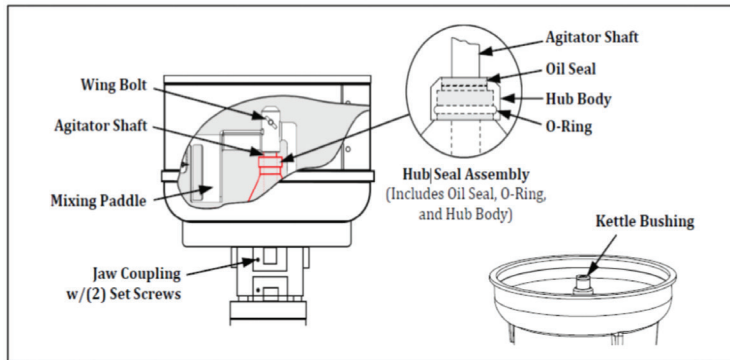

With the machine OFF, unplug the unit and allow it to cool before attempting to clean the Hub Seal Assembly.

1

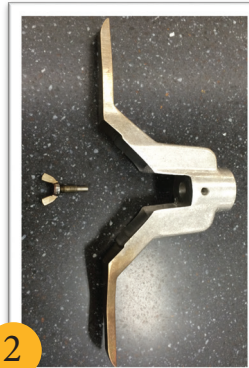

Remove paddle via the small wing nut lock stud. Remove any burrs on the shaft using a fine grit emery paper to lightly sand the surface. If burrs are not removed, damage may occur to the o-ring/oil seal during removal/installation.

3



Remove the hub seal assembly and soak it in hot water to clean. Clean the area around the center hub and remove any product residue.

4



Lightly lubricate the center hub of the kettle with a small amount of vegetable oil to allow for easy re-installation of the hub seal assembly.

5



Slide the clean hub seal down the agitator shaft. Apply pressure to ease the assembly over the center hub of the kettle until it seats properly.

6



After the hub seal assembly has been properly installed, re-install the mixing paddle onto the agitator shaft. Finger tighten the wing bolt to secure the mixing paddle in place.



GOLD MEDAL®
Snacks, Smiles & Success!®



800-543-0862 | gmpopcorn.com